

台灣的品牌，耐用耐操的代言者 LONG-GOOD 高壓吸送風機和透浦式鼓風機
30年專業製造經驗，為您解決尋找優質鼓風機的困擾
PROFESSIONAL MANUFACTURE OF
HIGH-PRESSURE BLOWER AND TURBO BLOWER

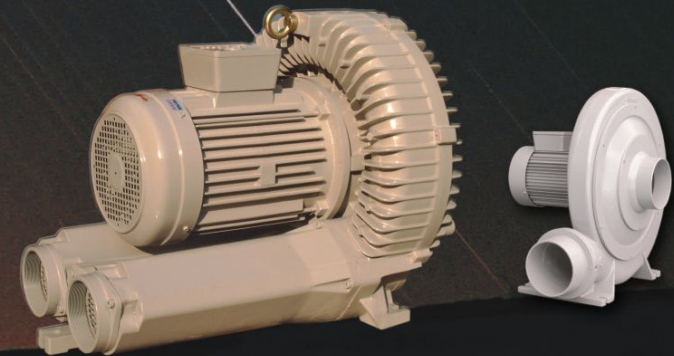

無油、無污染
NO Oil, No Pollution
低噪音
Low Noise
低震動
Low Vibration
高風壓
High Air Pressure
吸送風皆可
Dual Blow/Suction
高效率
High Efficiency
低耗能
Low Energy Loss
品質穩定
Steady Quality
壽命長，用者肯定
Life Span with
Customer's Satisfy

榮獲台灣
跨世紀
十大企業金鼎獎

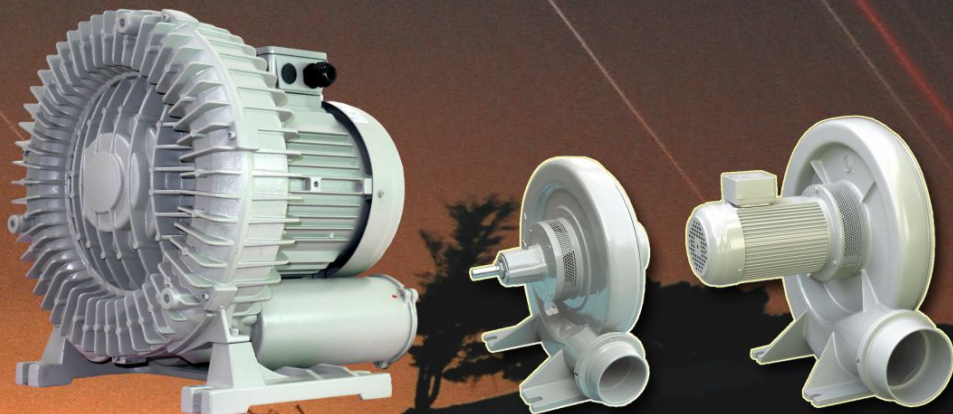

F級絕緣馬達，高耐溫
鋁合金製造，機殼特厚
結構堅固，抗氧化，耐磨耐壓

洩壓閥(風壓風量調節閥)

1. 釋放鼓風機多餘的壓力，使鼓風機馬達維持在安全電流內使用，以避免馬達過載。
 2. 安裝於鼓風機出入口之外接金屬管側，為吸吐兩用洩壓閥。
 3. 整體為鋁合金製造，可耐至攝氏500度之高溫，堅固、耐用、美觀。
- Pressure release valve (regulating valve for wind pressure and wind intensity)
1. Release the redundant pressure from the blower so as to keep the motor of the blower in operation within safe current limit, and avoid overload.
 2. The pressure release valve which inhales and vents air is externally installed to one side of the metal pipe at the mouth of the blower.
 3. The whole blower cabinet is made of aluminum alloy to resist a high temperature of 500°C. It is rigid, durable and nice-looking.

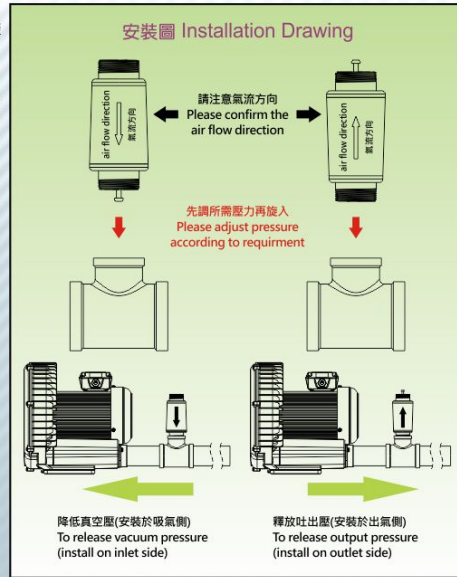

空氣過濾器

鼓風機入風口應加裝空氣過濾器以防止鼓風機吸到螺絲、破布...等異物，這些異物在鼓風機運轉時有可能導致機身破裂、風扇斷裂、機體異常震動、馬達故障等現象發生。

Air Filter

The air inlet of the blower should be assted with an air filter to prevent the blower sucking screw, ragged cloth and useless objects. These useless objects inside the blower may result in crack with the blower cabinet, breakage with the vanes abnormal vibration while the blower is in operation.

| 型號 Model No. | 口徑 Caliber (inch) | B (mm) | D (mm) | H (mm) | H1 (mm) | 過濾精度 filter net density | 概略重量 Approx. weight (kg) |
|-----------------|----------------------|--------|--------|--------|---------|----------------------------|-----------------------------|
| MF-8 | 1 | 46 | 61 | 169 | 159 | 100目 | 0.24 |
| MF-10 | 1-1/4 | 52 | 75 | 181 | 171 | | 0.32 |
| MF-12 | 1-1/2 | 60 | 85 | 195 | 186 | | 0.4 |
| MF-16 | 2 | 73 | 107 | 211 | 201 | | 0.6 |
| MF-20 | 2-1/2 | 90 | 148 | 275 | 247 | | 1.55 |
| MF-32 | 4 | 146 | 210 | 365 | 350 | | 3.37 |

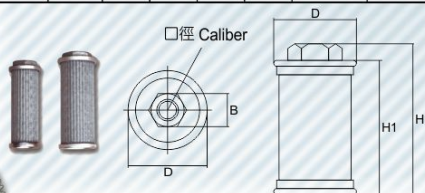

消音器

針對需要低噪音的客戶所設計。整體用金屬製作而成，消音器兩端皆有螺紋，可用旋轉固定於鐵管牙中，此裝置可用於鼓風機的出入口端或管線的末端，安裝方便，堅固耐高溫，且壽命長，最重要的是降低噪音的效率，請多加利用。

Silencer

It is specially designed for the customers who need low noises. The whole muffler is made of metal. The two ends of the silencer have threads which can screw in to match the applied to the mouth of the blower or the terminal of the pipe for easy installation. The silencer is rigid and high temperature resistance, and has a long service life. The most importance is to lower noises efficiently. Suggest you to make good use of it.

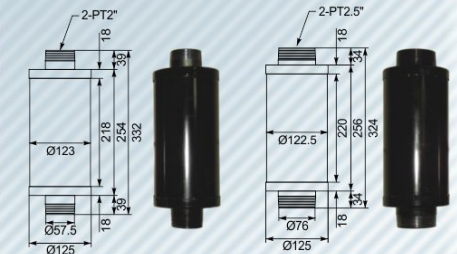

| 型號 TYPE | 口徑 Orifice | 適用機種 Suitable Models |
|----------|------------|-------------------------------------|
| ES-2 | 2" | LG-5068A, LG-5068, LG-6068, LG-7068 |
| ES-2-1/2 | 2.5" | LG-8068, LG-9068 |



LG-006
1/8HP



LG-106
1/6HP



LG-2068
1/2HP



LG-3068
1HP



LG-5068
2HP

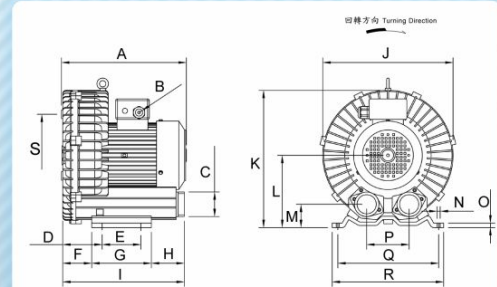

| 型號 TYPE | 尺寸 Measurement (mm) | | | | | | |
|------------|---------------------|------|-----------|-----|-----|----|-----|
| | A | B | C | D | E | F | G |
| LG-006 | 162 | | Ø26 | 87 | | 49 | 75 |
| LG-106 | 210 | Ø10 | PT 1" | 90 | | | 85 |
| LG-2068 | 246 | M16B | PT 1 1/4" | 65 | 83 | 52 | 110 |
| LG-3068 | 286 | M16B | PT 1 1/2" | 100 | 95 | 79 | 137 |
| LG-5068 | 330 | M16B | PT 2" | 74 | 115 | 60 | 157 |

| 型號 TYPE | 尺寸 Measurement (mm) | | | | | | |
|------------|---------------------|-----|-----|-----|-----|----|-----|
| | H | I | J | K | L | M | N |
| LG-006 | 42 | 164 | 148 | 152 | 79 | 20 | Ø7 |
| LG-106 | 90 | 220 | 200 | 215 | 105 | 35 | Ø10 |
| LG-2068 | 86 | 248 | 242 | 262 | 134 | 44 | Ø8 |
| LG-3068 | 48 | 264 | 286 | 300 | 149 | 46 | Ø12 |
| LG-5068 | 98 | 315 | 333 | 342 | 179 | 56 | Ø10 |

| 型號 TYPE | 尺寸 Measurement (mm) | | | | |
|------------|---------------------|-----|-----|-------|-------------|
| | O | P | Q | R | S |
| LG-006 | 10 | 62 | 130 | 143.8 | |
| LG-106 | 9 | 70 | 165 | 192 | |
| LG-2068 | 9 | 91 | 205 | 232 | |
| LG-3068 | 7 | 115 | 225 | 257 | |
| LG-5068 | 13 | 120 | 260 | 296 | Ø200-3*120° |



LONG-GOOD
高壓吸送風機
High Pressure Blower

SERVE-WELL
ENTERPRISE CO., LTD.



LONG-GOOD
高壓吸送風機規格表
High Pressure Type

SERVE-WELL
ENTERPRISE CO., LTD.



LG-6068
3HP



LG-7068
5HP



LG-8068
7-1/2HP



LG-9068
10HP



LG-1506
15HP

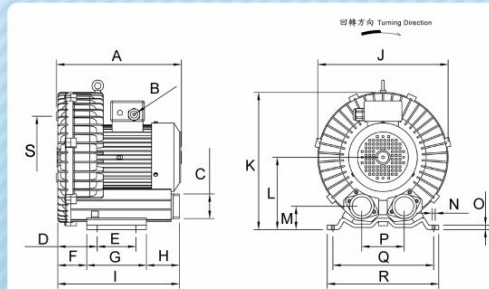

| 型號 TYPE | 尺寸 Measurement (mm) | | | | | | |
|------------|---------------------|------|--------|-----|-----|----|-----|
| | A | B | C | D | E | F | G |
| LG-6068 | 364 | PG21 | PT 2" | 100 | 140 | 86 | 177 |
| LG-7068 | 384 | PG21 | PT 2" | 100 | 140 | 86 | 177 |
| LG-8068 | 480 | PG21 | PT 2½" | 29 | 280 | 11 | 315 |
| LG-9068 | 480 | PG21 | PT 2½" | 29 | 280 | 11 | 315 |
| LG-1506 | 590 | PG21 | PT 4" | 95 | 610 | | |

| 型號 TYPE | 尺寸 Measurement (mm) | | | | | | |
|------------|---------------------|-----|-----|-----|-----|----|-----|
| | H | I | J | K | L | M | N |
| LG-6068 | 90 | 353 | 384 | 340 | 210 | 58 | Ø12 |
| LG-7068 | 90 | 353 | 384 | 340 | 210 | 58 | Ø12 |
| LG-8068 | 164 | 490 | 460 | 500 | 275 | 89 | Ø16 |
| LG-9068 | 164 | 490 | 460 | 500 | 275 | 89 | Ø16 |
| LG-1506 | | 730 | 550 | 575 | 300 | 90 | |

| 型號 TYPE | 尺寸 Measurement (mm) | | | | |
|------------|---------------------|-----|-----|-----|-------------|
| | O | P | Q | R | S |
| LG-6068 | 13 | 123 | 290 | 326 | Ø240-3*120° |
| LG-7068 | 13 | 123 | 290 | 326 | Ø240-3*120° |
| LG-8068 | 30 | 145 | 365 | 417 | Ø406-3*120° |
| LG-9068 | 30 | 145 | 365 | 417 | Ø406-3*120° |
| LG-1506 | 23 | 210 | 360 | 405 | |

| 相位 Phase | 型號 Model | 額定出力 Max. power (KW) | 額定電流 Rated current 220/380 | 最大吐出壓力 Max. blowing pressure (mmAq) | 最大真空壓力 Max. Vacuum pressure (mmAq) | 最大吐出風量 Max. blowing wind-force (m³/min) | 噪音值 Noise Value (dB) | 吸出口徑 In/Out Orifice (inch) | 重量 weight (kg) | 尺寸 (長×寬×高) Dimension L×W×H (mm) | |
|---------------------------|-----------------------------------|-------------------------|-------------------------------|--|---------------------------------------|--|-------------------------|-------------------------------|-------------------|---------------------------------------|--|
| 三相 標準型 Three-Phase | 50Hz IP54 200~230/380~400V | | | | | | | | | | |
| | LG-006 | 0.06 | 0.4/0.3 | 230 | 170 | 0.3 | 52 | 26mm | 4.5 | 148×162×152 | |
| | LG-106 | 0.09 | 0.5/0.3 | 500 | 475 | 0.75 | 52 | 1 | 7 | 220×200×215 | |
| | LG-2068 | 0.4 | 1.6/0.9 | 1100 | 1000 | 1.33 | 61 | 1-1/4 | 12 | 248×242×262 | |
| | LG-3068 | 0.8 | 3.5/1.9 | 2000 | 1500 | 2.4 | 68 | 1-1/2 | 17 | 270×286×300 | |
| | LG-5068 | 1.75 | 5.8/3.5 | 2900 | 2400 | 3.5 | 75 | 2 | 27 | 330×333×342 | |
| | LG-6068 | 2.2 | 12/6.9 | 3400 | 2500 | 6 | 75 | 2 | 35 | 364×384×340 | |
| | LG-7068 | 3.7 | 13/7.5 | 3400 | 2500 | 6.5 | 75 | 2 | 36 | 384×384×340 | |
| | LG-8068 | 5.5 | 20/11.5 | 3500 | 2750 | 9.5 | 76 | 2-1/2 | 76 | 490×460×500 | |
| | LG-9068 | 7.5 | 26/15 | 3500 | 2750 | 10 | 76 | 2-1/2 | 76 | 490×460×500 | |
| | LG-1506 | 11 | 20/11.5 | 3600 | 2700 | 14.2 | 82 | 4 | 123 | 730×550×575 | |
| | 60Hz IP54 200~240/380~400V | | | | | | | | | | |
| | LG-006 | 0.1 | 0.4/0.3 | 300 | 230 | 0.5 | 55 | 26mm | 4.5 | 148×162×152 | |
| | LG-106 | 0.13 | 0.6/0.4 | 650 | 600 | 0.91 | 55 | 1 | 7 | 220×200×215 | |
| LG-2068 | 0.5 | 1.8/1.0 | 1500 | 1300 | 1.55 | 63 | 1-1/4 | 12 | 248×242×262 | | |
| LG-3068 | 0.9 | 4.2/2.2 | 2800 | 2100 | 2.65 | 69 | 1-1/2 | 17 | 270×286×300 | | |
| LG-5068 | 1.9 | 7.0/4.0 | 4000 | 2800 | 3.9 | 78 | 2 | 27 | 330×333×342 | | |
| LG-6068 | 2.6 | 13/7.5 | 4350 | 3000 | 6.5 | 80 | 2 | 35 | 364×384×340 | | |
| LG-7068 | 4 | 14/8.0 | 4350 | 3000 | 7 | 80 | 2 | 36 | 384×384×340 | | |
| LG-8068 | 6 | 25/15 | 4750 | 3550 | 11 | 86 | 2-1/2 | 76 | 490×460×500 | | |
| LG-9068 | 8 | 30/19 | 4750 | 3550 | 11.5 | 86 | 2-1/2 | 76 | 490×460×500 | | |
| LG-1506 | 12 | 26/15 | 4800 | 3550 | 17.1 | 87 | 4 | 123 | 730×550×575 | | |
| 單相 標準型 Single-Phase | 50Hz 110~115/200~230V | | | | | | | | | | |
| | LG-006A | 0.06 | 0.6/0.3 | 230 | 170 | 0.3 | 52 | 26mm | 4.5 | 148×162×152 | |
| | LG-106A | 0.09 | 1.3/0.7 | 500 | 490 | 0.75 | 52 | 1 | 7 | 220×200×215 | |
| | LG-2068A | 0.4 | 4.0/2.0 | 1100 | 1000 | 1.33 | 61 | 1-1/4 | 12 | 248×242×262 | |
| | LG-3068A | 0.8 | 10.5/4.8 | 1900 | 1400 | 2.4 | 68 | 1-1/2 | 17 | 270×286×300 | |
| | 50Hz 200~230V | | | | | | | | | | |
| | LG-5068A | 1.75 | 10 | 2800 | 2300 | 4.2 | 75 | 2 | 27 | 330×333×342 | |
| | 60Hz 110~115/200~240V | | | | | | | | | | |
| | LG-006A | 0.1 | 0.6/0.3 | 290 | 230 | 0.5 | 55 | 26mm | 4.5 | 148×162×152 | |
| | LG-106A | 0.13 | 1.9/1.2 | 650 | 650 | 0.9 | 55 | 1 | 7 | 220×200×215 | |
| | LG-2068A | 0.5 | 5.8/2.8 | 1500 | 1300 | 1.55 | 63 | 1-1/4 | 12 | 248×242×262 | |
| | LG-3068A | 0.9 | 12/6.0 | 2500 | 2000 | 2.65 | 69 | 1-1/2 | 17 | 270×286×300 | |
| | 60Hz 200~240V | | | | | | | | | | |
| | LG-5068A | 1.9 | 10 | 3800 | 2400 | 4.6 | 78 | 2 | 27 | 330×333×342 | |

● 訂貨時，請註明型號、電壓及週波數。
● 由於技術上的需要，本公司保留設計與變更的權利。
● 鼓風機使用時，最大電流值請勿超過額定電流，以維護鼓風機壽命。
● For using the blower, the maximum current value does not exceed the rated current so as to keep the blower long service life.
● Due to the technology requirement, we reserve the right to redesign and alter the products.
● Please indicate the voltage and frequency of the blower when place an order.

● 更多規格請來電洽詢。



LONG-GOOD
透浦式鼓風機
Turbo Blower

SERVE-WELL
ENTERPRISE CO., LTD.



LONG-GOOD
透浦式鼓風機
Turbo Blower

SERVE-WELL
ENTERPRISE CO., LTD.

CX-1/4
0.18KW

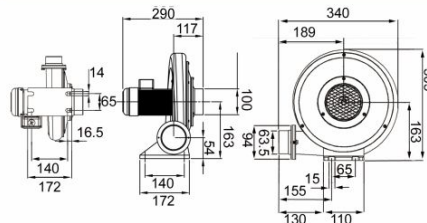
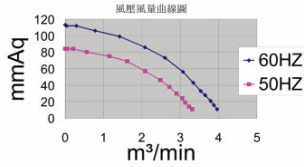

CX-1/2
0.4KW

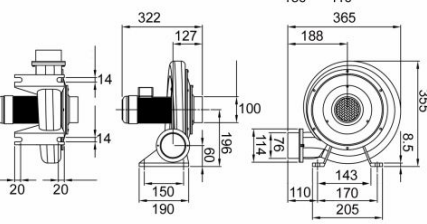
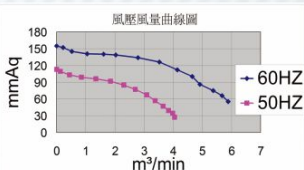

CX-1
0.75KW

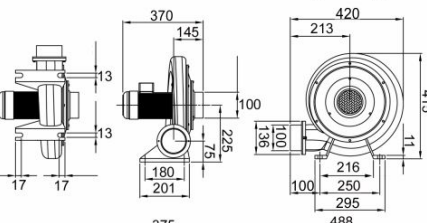
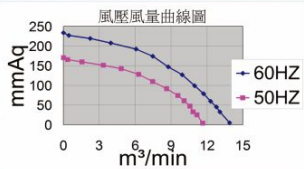

CX-2
1.5KW

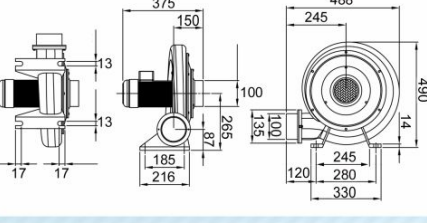
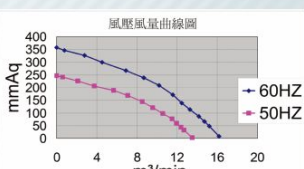

●由於技術上的需要我們保留設計與尺寸變更的權利。訂購時請註明型號、電壓及週波數與吸風口是否要裝配風量調節盤。

| 型號 Type No. | 功率 Power (KW) | 電壓 Voltage (V) | 週率 Frequency (Hz) | 轉速 R.P.M. | 噪音值 Noise value dB | 額定電流 Rated current (A) | 最大靜壓 Max. static pressure (mmAq) | 最大風量 Max. blowing wing-force (m³/min) | 概略重量 Approx. weight (kg) |
|----------------|------------------|-------------------|----------------------|--------------|-----------------------|---------------------------|-------------------------------------|--|-----------------------------|
| CX-1/4 | 0.18 | 200~230 | 50 | 2800 | 50 | 2.0 | 84 | 3.3 | 11 |
| | | 60 | 3500 | 62 | 1.5 | 113 | 3.9 | | |
| | | 380~415 | 50 | 2800 | 50 | 1.3 | 84 | 3.3 | |
| CX-1/2 | 0.4 | 200~230 | 50 | 2800 | 58 | 2.5 | 113 | 4.1 | 17 |
| | | 60 | 3500 | 70 | 1.8 | 155 | 5.9 | | |
| | | 380~415 | 50 | 2800 | 58 | 1.5 | 113 | 4.1 | |
| CX-1 | 0.75 | 200~230 | 50 | 2800 | 64 | 3.3 | 170 | 11.6 | 22 |
| | | 60 | 3500 | 80 | 2.8 | 234 | 13.9 | | |
| | | 380~415 | 50 | 2800 | 64 | 2.0 | 170 | 11.6 | |
| CX-2 | 1.5 | 200~230 | 50 | 2800 | 72 | 5.4 | 247 | 13.5 | 27 |
| | | 60 | 3500 | 90 | 4.5 | 358 | 16.2 | | |
| | | 380~415 | 50 | 2800 | 72 | 3.1 | 247 | 13.5 | |
| | | | 60 | 3500 | 90 | 2.6 | 358 | 16.2 | |

CX-3
2.2KW

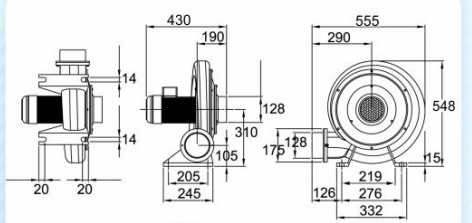
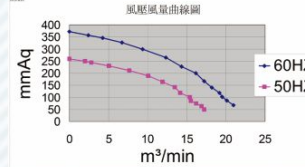

CX-5
3.7KW

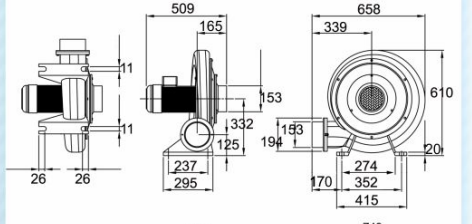
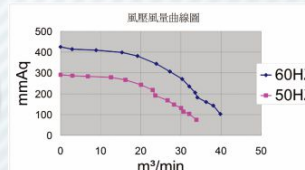

CX-7.5
5.5KW

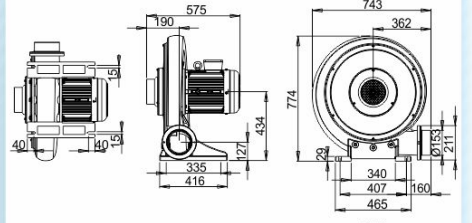
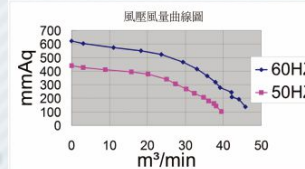

CX-10
7.5KW

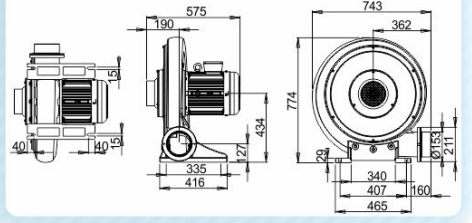
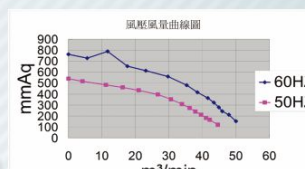

●由於技術上的需要我們保留設計與尺寸變更的權利。訂購時請註明型號、電壓及週波數與吸風口是否要裝配風量調節盤。

| 型號 Type No. | 功率 Power (KW) | 電壓 Voltage (V) | 週率 Frequency (Hz) | 轉速 R.P.M. | 噪音值 Noise value dB | 額定電流 Rated current (A) | 最大靜壓 Max. static pressure (mmAq) | 最大風量 Max. blowing wing-force (m³/min) | 概略重量 Approx. weight (kg) |
|----------------|------------------|-------------------|----------------------|--------------|-----------------------|---------------------------|-------------------------------------|--|-----------------------------|
| CX-3 | 2.2 | 200~230 | 50 | 2800 | 76 | 8 | 259 | 17.2 | 35 |
| | | 60 | 3500 | 95 | 7 | 372 | 20.9 | | |
| | | 380~415 | 50 | 2800 | 76 | 4.6 | 259 | 17.2 | |
| CX-5 | 3.7 | 200~230 | 50 | 2800 | 80 | 13 | 291 | 33.9 | 47.5 |
| | | 60 | 3500 | 100 | 12 | 426 | 39.8 | | |
| | | 380~415 | 50 | 2800 | 80 | 7.5 | 291 | 33.9 | |
| CX-7.5 | 5.5 | 200~230 | 50 | 2800 | 84 | 20 | 441 | 39.5 | 95.8 |
| | | 60 | 3500 | 105 | 19 | 621 | 45.7 | | |
| | | 380~415 | 50 | 2800 | 84 | 12 | 441 | 39.5 | |
| CX-10 | 7.5 | 200~230 | 50 | 2800 | 86 | 26 | 534 | 39.0 | 96.8 |
| | | 60 | 3500 | 108 | 25 | 742 | 45.9 | | |
| | | 380~415 | 50 | 2800 | 86 | 15 | 534 | 39.0 | |
| | | | 60 | 3500 | 108 | 14 | 742 | 45.9 | |

我們對質量的要求，遠高於數量---5---我們對服務的重視，遠高於業務

我們對質量的要求，遠高於數量---6---我們對服務的重視，遠高於業務

