

# BAS Series Wastewater Pump

Applications: Water drainage for Civil engineering, Building, Engineering, Sewer, Agriculture, Fishery, Animal husbandry...etc.

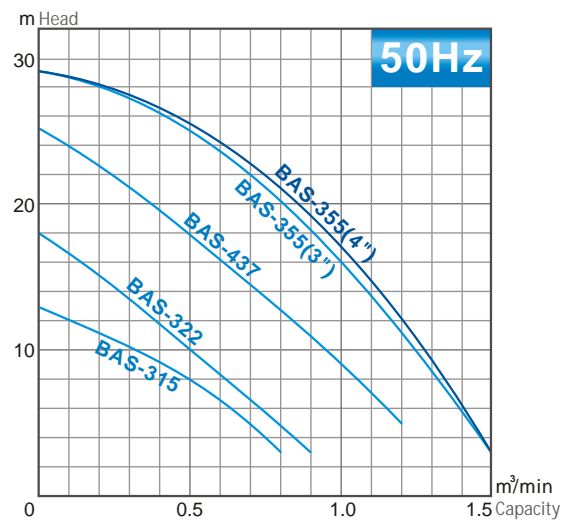

Stainless Steel Impeller



Spec. / Model	BAS-315	BAS-322	BAS-437	BAS-355
Discharge		80mm		80/100mm
Liquid	Sewage and Wastewater			
Temp.	0-40°C			
Motor	Freq. / Voltage	50Hz / 200V-460V		
	Motor type	Dry Motor		
	Pole	2P		
	Protect	AC Protector		
Pump	Shaft	SUS410		
	Mech. Seal	SIC / SIC		
	Impeller	Stainless Steel		
	Pump Housing	FC-20		

## SPECIFICATIONS

Model	Output Hp(kW)	Discharge inch	Phase $\phi$	Standard		Free Passage mm	Length mm	Width mm	Height mm	Weight kg
				Head m	Capacity m <sup>3</sup> /min					
BAS-315	2 (1.5)	3"	3 $\phi$	8	0.5	10	380	240	500	48
BAS-322	3 (2.2)	3"	3 $\phi$	10	0.5	10	380	240	520	55
BAS-437	5 (3.7)	3"	3 $\phi$	18	0.5	10	500	260	560	62
BAS-355	7½ (5.5)	3"	3 $\phi$	25	0.5	10	500	260	590	67
BAS-355	7½ (5.5)	4"	3 $\phi$	17	1	10	500	260	590	67



50HZ

CAST IRON PUMP

Sewage / Wastewater pump



WATER POWER ALL IN SONHO PUMP



SONHO PUMP MANUFACTURING CO., LTD.  
<http://www.sonho.com.tw> E-mail: [sonho@sonho.com.tw](mailto:sonho@sonho.com.tw)  
 TEL: +886-8-7559933 FAX: +886-8-7557575



Made In Taiwan



## SONHO CAST IRON PUMP - 6 mainly characters

1. Full series adopted **Stainless Steel Shaft and Impeller**.
2. Dry motors design, and with AC protector for motor protection.
3. All cables are injected with EPOXY resin sealed water-resistant cables base.
4. Full series use F grade insulation motor and SIC Mechanical Seal.
5. All assembly process examined by precise electronic leakage instrument for high QC.
6. All assembly components are made in Taiwan.

## BCF Series Sewage / Wastewater / Non-Clogging Pump

Applications: Drain accumulated water and wastewater from husbandry, industry, basement, food factory...etc.



BCF-437

BCF-355

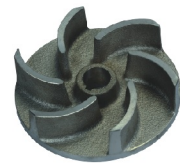

Stainless Steel Impeller

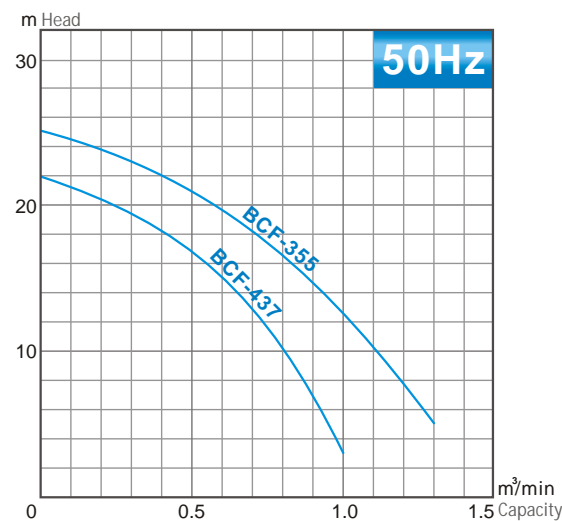

Spec. / Model	BCF-437	BCF-355
Discharge	80mm	80/100mm
Liquid	Sewage and Wastewater	
Temp.	0-40°C	
Motor	Freq. / Voltage	50Hz / 200V-460V
	Motor type	Dry Motor
	Pole	2P
	Protect	AC Protector
Pump	Shaft	SUS410
	Mech. Seal	SIC / SIC
	Impeller	Stainless Steel
	Pump Housing	FC-20

### SPECIFICATIONS

Model	Output Hp(kW)	Discharge inch	Phase $\phi$	Standard		Free Passage mm	Length mm	Width mm	Height mm	Weight kg
				Head m	Capacity m³/min					
BCF-437	5 (3.7)	3"	3 $\phi$	17	0.5	60	500	260	550	62
BCF-355	7½ (5.5)	3"-4"	3 $\phi$	21	0.5	65	500	260	580	67

## BFS Series Sewage / Wastewater Pump

Applications: Drain accumulated water and wastewater from husbandry, industry, basement, food factory...etc.



BFS-315

BFS-322

BFS-437

BFS-355



Stainless Steel Impeller

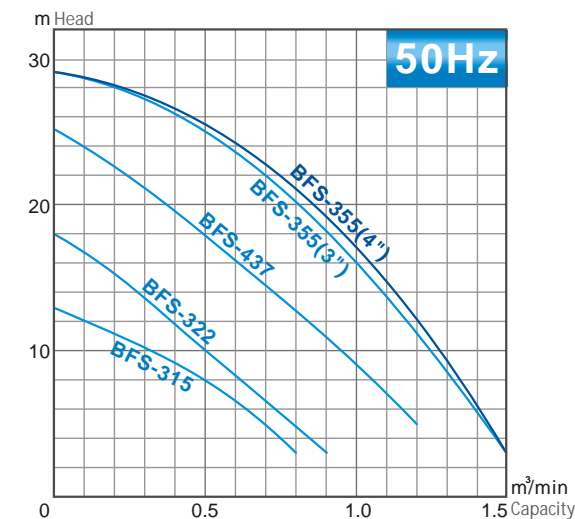

Spec. / Model	BFS-315	BFS-322	BFS-437	BFS-355
Discharge	80mm			80/100mm
Liquid	Sewage and Wastewater			
Temp.	0-40°C			
Motor	Freq. / Voltage	50Hz / 200V-460V		
	Motor type	Dry Motor		
	Pole	2P		
	Protect	AC Protector		
Pump	Shaft	SUS410		
	Mech. Seal	SIC / SIC		
	Impeller	Stainless Steel		
	Pump Housing	FC-20		

### SPECIFICATIONS

Model	Output Hp(kW)	Discharge inch	Phase $\phi$	Standard		Free Passage mm	Length mm	Width mm	Height mm	Weight kg
				Head m	Capacity m³/min					
BFS-315	2 (1.5)	3"	3 $\phi$	8	0.5	20	400	240	500	48
BFS-322	3 (2.2)	3"	3 $\phi$	10	0.5	20	400	240	520	55
BFS-437	5 (3.7)	3"	3 $\phi$	18	0.5	25	500	260	560	62
BFS-355	7½ (5.5)	3"	3 $\phi$	25	0.5	30	500	260	590	67
BFS-355	7½ (5.5)	4"	3 $\phi$	17	1	30	500	260	590	67